

STC 55

GREEN GLUE ASSEMBLY

Wall	5/8" Drywall Green Glue (2 tubes per 4'x8' sheet) + 5/8" Drywall
Framing	2x4 Wood Stud (24" OC)
Insulation	R13 fiberglass insulation
Wall	5/8" drywall + Green Glue @ 2 tubes per 4'x8' sheet + 5/8" drywall
Orfield Labs NVLAP certified	OL-05-1049

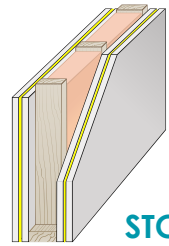

STC 45

ENGINEERED DAMPING GLUE

Wall	5/8" drywall + Engineered Damping Glue @ 2.5 tubes per 4'x8' sheet + 5/8" drywall
Framing	2x4 Wood Stud (24" OC)
Insulation	R13 fiberglass insulation
Wall	5/8" drywall + Engineered Damping Glue @ 2.5 tubes per 4'x8' sheet + 5/8" drywall
Orfield Labs NVLAP certified	OL 06-0940

Engineered damping glue was purchased by independent contractors through standard retail channels.

Independent contractor assembly was conducted under lab supervision at Orfield Laboratories.

Glue was applied according to the manufacturer's instructions.

The processed was filmed and a wall sample retained by the lab.

See certified test report for more details.

